



# UNIVERSAL MILLS

## REKORD 224 - 630 GMP



### MATERIAL EXAMPLES

- active pharmaceutical ingredients
- dry herbal extracts
- natrium chlorate
- cell culture feed
- plastic granules
- lupine proteins
- cellulose
- salts

# UNIVERSAL MILLS





## REKORD 224 - 630 GMP

The universal mills series REKORD 224-630 GMP has been designed in conformity with hygienic design and GMP standards. Ability for simple dismantling and efficient cleaning was the design target and is a key feature of this series, meeting the requirements for validated hygienic processes. The precise housings and grinding elements of the REKORD 224 - 630 are dead-leg-free and made of specially alloyed, polished steels. All sealing systems are compliant to pharma- and food production standards. The mills are custom configured by material, target grain size and capacity requirements with flexible grinding elements, drives and sensors. The dust-proof integral GMP-CUBE body is a statement for precise, robust quality.

### KEY FEATURES OF REKORD 224-630 GMP UNIVERSAL MILLS:

- modular systems for high flexibility in grinding elements and material handling
- circumferential / impact speed up to 210 m/s
- mill housings in precise, dust proof and robust design (GMP-CUBE)
- material in contact with product is stainless steel ( $Ra \leq 0,8 \mu m$ )
- for cryogenic milling and inertisation
- 10 bar pressure shock resistant in all design sizes
- variable speed adjustment for result variation
- long running, low-maintenance systems
- remote-maintenance ready
- ATEX conformity
- full IQ/OQ/PQ validation

### CONFIGURATION

Mill type	Grinding elements	Application
<b>Pin mill</b> No sieve insert, pins made of stainless steel or hard metal. Operation can be Rotor/Stator and counter-rotating: Rotor/Rotor		High degree of required fineness with already low feed grain size. Recommended for brittle materials in pharma, chemical, foodstuff production
<b>Turbo mill</b> with various options for sieve inserts and an optional grinding track		High degree of required fineness with medium feed grain size. Recommended for fibrous, crystalline, heat-sensitive materials with low fat content.
<b>Beater mill</b> with sieve grate, grinding ring and optional grinding track		Medium required fineness with coarse feed grain size. Recommended for hard and fibrous materials, e.g. cocoa, coffee and a number of building materials.
<b>Ripple disc mill</b> with rotor und stator		Medium required fineness with coarse feed grain size. Recommended for fibrous materials, e.g. crops, cellulose, herbal feed.

The mills are equipped with automated pedestal body lubrication, cycle, temperature and vibration monitoring. The customer specific layout is defined based on milling trials and production targets.



## TECHNICAL DATA

Design size/ model	REKORD 224	REKORD 315	REKORD 450	REKORD 630	REKORD 630–2SSt
Max. drive power (kW)	15	37	75	160	160
Rotor size (mm)	224 (8.8")	315 (12.4")	450 (17.7")	630 (24.8")	630 (24.8")
Max. circumferential speed (m/s)	200	210	176	180	180
Max. capacity (kg/h)	200	800	> 1.000	> 2.000	> 5.000

## COMPONENTS (selection)

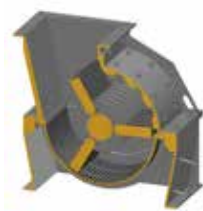

pre-crushing



dosing



pneumatic conveying



filter separator

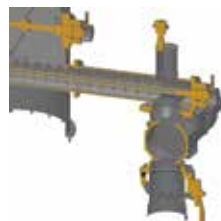

discharge



buffer container with agitator

## OPTIONS

Request your specific mill layout. We prepare your customized solution based on our modular system and integrate the mill into your production environment. Ask us for peripheral components like mill charge and discharge, dosing and weighing solutions, metal separators and sieves, bag and big bag discharge and charging stations as well as comprehensive pneumatic transport solutions to and from the mill including filter systems.

## FULL SERVICE

Optimize the operational performance of your plant with our dedicated maintenance services. We warrant short term availability of original spare parts throughout the life time of your plant.

Milling trials  
& Analysis

Project planning  
& Engineering

Manufacturing  
& Installation

Training  
& Commissioning

Maintenance  
& Service



+49 35242 432 30



WWW.JEHMLICH.INFO



REKORD 315 GMP fine grinding plant for cell culture feed



REKORD 630 GMP fine grinding plant for lactose



Pin grinding element REKORD 315-GMP